

## CLOCK



Un piccolo proiettore circolare dal design essenziale e di carattere, CLOCK è uno spotlight versatile e preciso. Spessore contenuto ed elegante orientabilità, con le sue due dimensioni offre grande qualità illuminotecnica, grazie ai performanti LED ed alle ottiche accuratamente studiate per permettere svariate modalità di impiego del flusso luminoso.

Gli accessori a corredo incrementano le tipologie di installazione ed il comfort visivo di CLOCK con stile - soluzioni puntuali per un'illuminazione d'accento scenografico e vibrante.

A small circular projector with an essential design and character, CLOCK is a versatile and precise spotlight. Low thickness and elegant adjustability, with its two dimensions it offers great lighting quality, thanks to the high-performance LEDs and specific designed optics to allow various ways of using the luminous flux.

The accessories supplied increase the types of installation and the visual comfort of CLOCK with style - punctual solutions for scenographic and vibrant accent lighting.

## SPOTLIGHT

CLOCK  
Ø 80CLOCK  
Ø 120

# CLOCK

## Spessore ridotto

Lo spessore di soli 36 mm per i due diametri consente un inserimento non invasivo negli ambienti esterni.

## Reduced thickness

Its 36 mm thickness for both diameters allows to fix CLOCK discreetly in outdoor settings.

Il corpo in alluminio ruota intorno al perno di fissaggio per facilitare l'orientamento sul piano verticale. Il blocco è garantito da una vite 8MA. Due asole sulla base consentono l'orientamento orizzontale  $\pm 40^\circ$ .

The aluminium body rotates around the locking pin on the vertical surface to easily adjust its direction. An 8MA screw locks it in place. Two eyelets on the base allow for a  $\pm 40^\circ$  horizontal adjustment.



## Cablaggio stagno

CLOCK è ermeticamente chiuso con resina bicomponente e fornito con 1,5 m di cavo interrabile H05RN-F. Il cavo può passare nell'apposito foro della basetta del braccio.

- Pressacavo in ottone
- Resinatura Acquastop
- Cavo antistrappo

## Watertight wiring

CLOCK is hermetically sealed with a two-component resin and provided with an 1,5 m H05RN-F cable. The cable can pass through a special hole in the base of the arm.

- Brass cable gland
- Aquastop Resin Finish
- Anti-tear cable

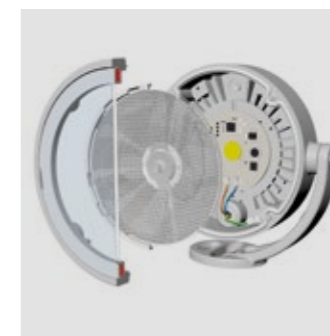
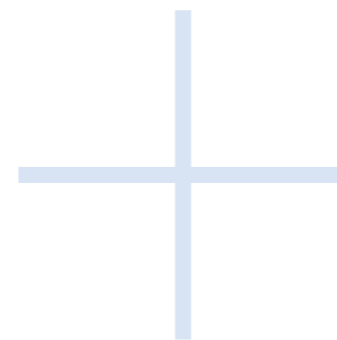

## Vetro sigillato

Il vetro frontale temprato trasparente ultrawhite è sigillato alla cornice di chiusura per consentire la massima tenuta.

## Sealed glass

The front tempered ultrawhite clear glass is sealed to the frame for a perfect watertight.

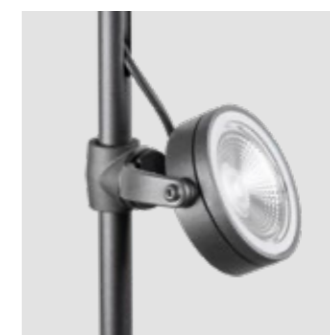

## Stelo da giardino

Stelo da giardino in alluminio estruso, predisposto per passaggio cavi (max 2) grazie ad apposite asole.

## Garden stem

Garden stem in extruded aluminium, suitable for cable entry (max 2) thanks to dedicated slots.





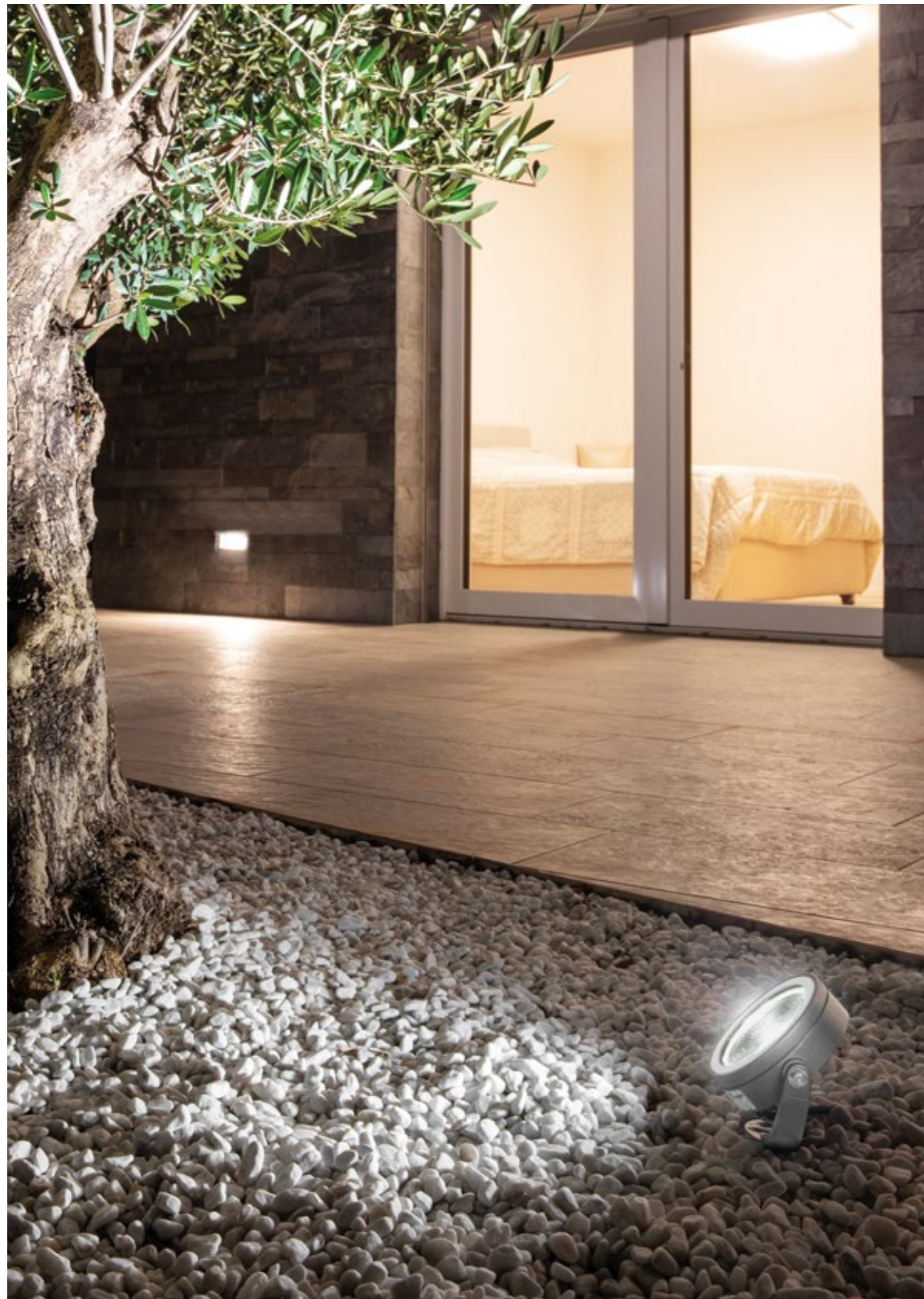



# CLOCK

Spot / Spotlight

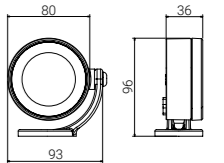

## CLOCK Ø 80 mm



	Code	
4661	 GR - graphite	3K - 3000 K
	 GM - metallized grey	4K - 4000 K



Lamp	W	Lm LED	Real Lm	Beam
LED	4	460	290	40°

Fasci opzionali / Optional beams 12° (code + 12), 90° (code + 90)  
 Fornita con 1,5 m di cavo interrabile / 1,5 m buriabile cable included  
 Modulo LED a tensione di rete, compatibile con dimmer a taglio di fase /  
 Mains voltage LED module, compatible with most phase-cut dimmers  
 Versione RGBW (vedi capitolo dedicato) / RGBW version (see dedicated chapter)

**Su richiesta / On Request**  
 2700K (code + 27K)  
 12-24V low voltage (code + LV)  
 Lunghezza cavo 7 m / 7 m cable length (code + MT7)  
 BI - white  CO - corten

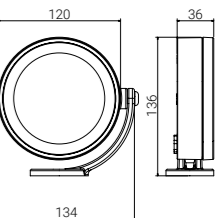
## CLOCK Ø 120 mm



	Code	
4664	 GR - graphite	3K - 3000 K
4665	 GM - metallized grey	4K - 4000 K

Lamp	W	Lm LED	Real Lm	Beam
LED	10	1100	750	40°
	15	1575	1050	

Fasci opzionali / Optional beams 12° (code + 12), 90° (code + 90)  
 Ottica a nido d'ape opzionale / Optional Honeycomb optic 10° (code + HC)  
 Fornite con 1,5 m di cavo interrabile / 1,5 m buriabile cable included  
 Modulo LED a tensione di rete, compatibile con dimmer a taglio di fase /  
 Mains voltage LED module, compatible with most phase-cut dimmers  
 Versione RGBW (vedi capitolo dedicato) / RGBW version (see dedicated chapter)

**Su richiesta / On Request**  
 2700K (code + 27K)  
 12-24V low voltage (code + LV)  
 Lunghezza cavo 7 m / 7 m cable length (code + MT7)  
 BI - white  CO - corten

# CLOCK

Accessori / Accessories



## VISIERA / SHIELD

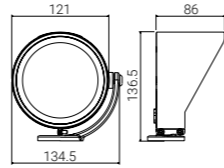

Code	Description	Ref. to
4669	GR - graphite	code 4664
	GM - metallized grey	code 4665

## GIUNTI STAGNI / WATERPROOF CONNECTIONS



code 1941



code 1942



code 1941

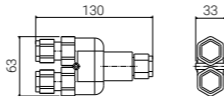

code 1942



code 1944

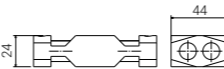

code 1944

Code	Description
1941	Connessione singola 3x2,5 mm <sup>2</sup> IP68 / Single connector 3x2,5 mm <sup>2</sup> IP 68
1942	Connessione entra-esce 3x2,5 mm <sup>2</sup> IP68 / Through wiring connector 3x2,5 mm <sup>2</sup> IP 68
1944	Connessione fino a 4 uscite 3x2,5 mm <sup>2</sup> IP68 (basato su gel siliconico bicomponente) / Up to 4 outputs connector 3x2,5 mm <sup>2</sup> IP 68, based on two-component silicone gel

# CLOCK

Accessori / Accessories



## PICCHETTO / SPIKE



Code	Description	Ref. to
4691	GR - graphite	code 4661
	GM - metallized grey	code 4664 code 4665

Altezza da terra consigliata: 10 cm come da normativa / Recommended height above ground: 10 cm in compliance with regulations

Il cavo può passare nell'apposito foro della basetta e nella struttura del picchetto / The cable can pass through a special hole in the base and through the structure of the spike

## BRACCIO A MURO / WALL ARM

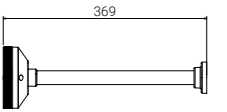

Code	Description	Ref. to
4692	GR - graphite	code 4661
	GM - metallized grey	code 4664 code 4665

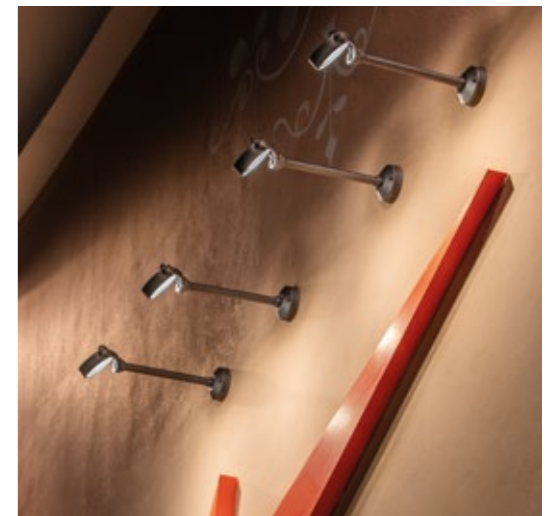







# CLOCK

Accessori / Accessories



# CLOCK

Accessori / Accessories



## STELI / STEMS



code 4693 GR

code 4694 GR

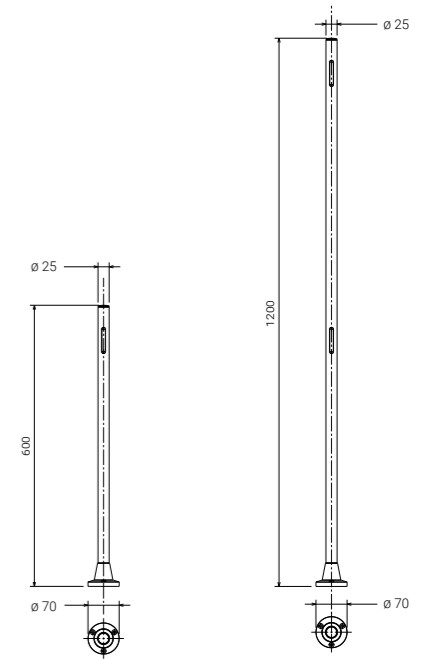

code 4693

code 4694



code 4695 GR

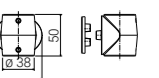

code 4695

Code	Description
4693	Stelo H 600 mm (1 asola) in alluminio estruso, base in alluminio pressofuso / Stem H 600 mm (1 slot) in extruded aluminium, base in die-cast aluminium
4694	Stelo H 1200 mm (2 asole) in alluminio estruso, base in alluminio pressofuso / Stem H 1200 mm (2 slots) in extruded aluminium, base in die-cast aluminium
4695	Raccordo scorrevole in alluminio pressofuso con relativa piastrina di fissaggio / Adjustable joint in die-cast aluminium with related fixing plate

4693, 4694 Max 2 cavi all'interno dello stelo / Max. 2 cables inside the stem

4694 Da montare obbligatoriamente con piastra 4697 / To be mandatorily installed with plate 4697

# CLOCK

Accessori / Accessories



## PICCHETTO / SPIKE



Code	Description	Ref. to
4696	Picchetto in policarbonato con piastra in acciaio inox AISI 304 / Spike in polycarbonate with plate in AISI 304 stainless steel	code 4693

## PIASTRA TIRAFONDI / PLATE WITH ANCHORING SET

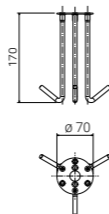

Code	Description	Ref. to
4697	Piastra in acciaio inox AISI 304 con tre tirafondi di ancoraggio / Plate in AISI 304 stainless steel with 3 ground anchors	code 4693 code 4694

## CASSAFORMA / IN-GROUND BOX

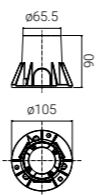

Code	Description	Ref. to
4698	Cassaforma per cablaggio interrato in tecnopolimero stabilizzato con anello in alluminio per fissaggio viti / In-ground box in waterproof technopolymer with aluminium ring to fix the screws	code 4693 code 4694

